

DIRECTIONS TO SUSQUEHANNA UNIVERSITY PARKING & FISHER HALL

Susquehanna University is in Selinsgrove PA. For GPS enter 514 University Ave, Selinsgrove, PA to get to the University.

The conference is in **Fisher Hall.** (Highlighted in YELLOW, #63 on the campus map on page 3.) The directions below pick up where Google maps, etc and your GPS leave off... the final steps to finding the parking at the conference site. For full directions, see the University site: <http://www.susqu.edu/admissions/1194.asp> . For further campus detail, see the campus map on page 3.



NOTE: Feel free to park in the spots designated for faculty/staff as the university is not in session on the day of the conference.

From the North...

- When 11&15 merge, you will continue south onto “the strip” (a stretch of highway marked by numerous businesses, gas stations, restaurants, etc.) You will go through 2 lights at the Monroe Marketplace where you’ll see signs for Target, Kohl’s, etc.
- Continue south past the Susquehanna Valley Mall (on your right) and further down, Sheetz convenience store (on your left)
- Go straight through the light where you see Sheetz
- You will cross over a small green bridge, and need to bear immediate Right onto Route 522
- Go straight through the traffic light (see Weis Markets on your right) and continue up the hill
- At the top of the hill, turn Left onto 18th St. where you see Susquehanna Bank on your left (Amato’s restaurant will be on your right; the turn is just before Susquehanna Bank)
- Continue all the way down 18th St.
- When you come to the 4-way stop, go straight and you’ll be on Susquehanna’s campus
- The **Degenstein parking lot** (Blue Highlighting on the campus map) will be down to your left.
- If the parking lot is full, you may go back to the 4-way stop and turn Right. You will pass the New Science Center on your left and then two houses. Turn left into the Admissions Parking lot (Pink Highlighting on the campus map) just after the second house.

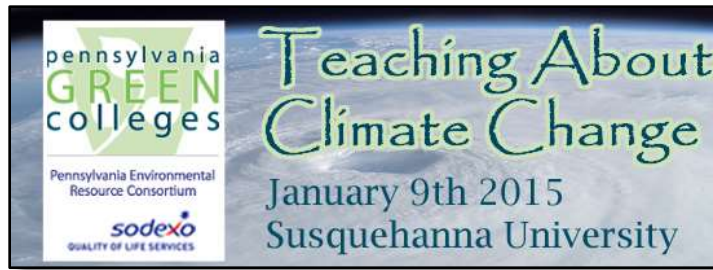

From the South...

- When you exit from Rte. 11 for Susquehanna University/Selinsgrove, you will turn Right at the end of the exit ramp
- Continue into town... you will come to a traffic light where Michael's Restaurant is on your right and First National Bank is on your left. TURN LEFT at this light onto Pine St.
- You will come to a stop sign, go straight.
- You'll begin to head uphill and will see campus on your left
- At the next stop sign (4-way stop, intersection w/ 18th St. and campus), turn LEFT into campus
- The Degenstein parking lot (Blue Highlighting on the campus map) will be down to your left.
- If the parking lot is full, you may go back to the 4-way stop and turn Right. You will pass the New Science Center on your left and then two houses. Turn left into the Admissions Parking lot (Pink Highlighting on the campus map) just after the second house.
-

Walking Directions to Fisher

From Degenstein Lot... (the closer lot)

- Walk down the road w/ the single parking row, between Weber Chapel (bldg. w/ steeple on the roof) and Degenstein Campus Center
- Take the sidewalk at the bend in the road that extends diagonally toward classroom buildings
- When the sidewalk reaches the road in front of the buildings, Fisher is the second building on your left.

From Admissions Lot (pink highlight) on University Ave...

- Walk up the street until you reach the crosswalk near the Communications house. Cross over University Ave. and continue straight on the path until you reach the road. Turn right and Fisher Hall will be on your right.

From the North

Susquehanna
UNIVERSITY

514 University Avenue
Selinsgrove, PA 17870
From the South
www.susqu.edu

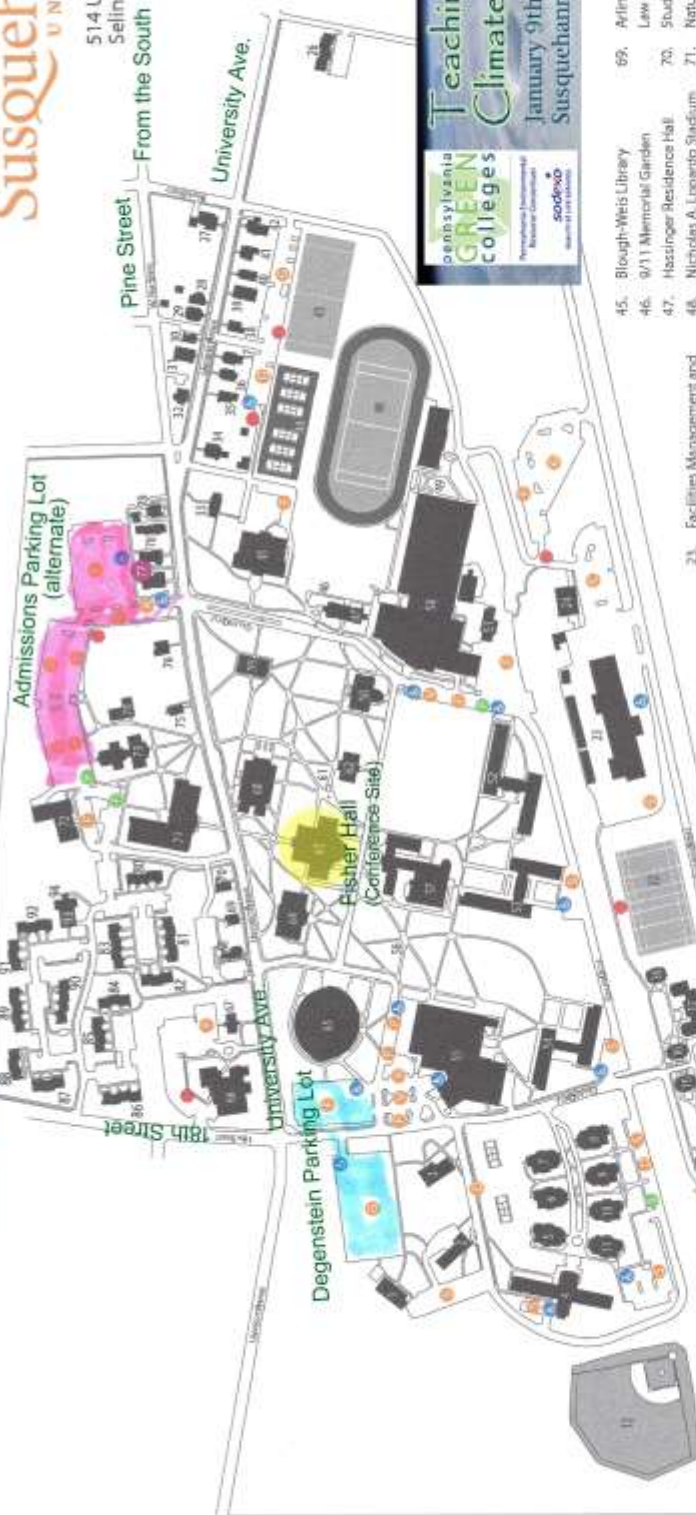

**Teaching About
Climate Change**
January 9th 2015
Susquehanna University

1. Tudor House
2. GO House
3. Scholars House
4. West Residence Hall
5. Hewthorn Residence Hall
6. Linden Residence Hall
7. Tamarack Residence Hall
8. Willow Residence Hall
9. Elm Residence Hall
10. Laurel Residence Hall
11. Aspen Residence Hall
12. Harold Bollinger
13. Baseball Field
14. Ross House
15. March Residence Hall
16. O'Connor House
17. Isaac House
18. Shubert Residence Hall
19. Roberts House
20. Faculty/Staff Residence
21. Sassafras Athletic Fields
22. Ecological Research Center
23. Rugby Field

23. Facilities Management and Central Recycling
24. TRAX
25. Science-in-Motion Program Office
26. Liberty Alley Apartments
27. Sigma Kappa Sorority
28. Tau Kappa Epsilon Fraternity
29. Student Housing
30. Student Housing
31. Student Housing
32. Hill Hall
33. Pine Lawn
34. Chaplain's Residence
35. Phi Mu Alpha Sorority
36. Student Housing
37. Zeta Tau Alpha Sorority
38. Presser International House
39. Kappa Delta Sorority
40. Faculty/Staff Residence
41. Student Housing
42. Alpha Delta Pi Sorority
43. Douglas E. Arthur Football Practice Field
44. Tennis Courts

45. Blough-Weis Library
46. 9/11 Memorial Garden
47. Hasting Residence Hall
48. Nicholas A. Luperto Stadium
49. Reunion Plaza
50. James W. Garrett
51. Sports Complex
52. Smith Residence Hall
53. Reed Residence Hall
54. Allentown Residence Hall
55. Charles B. Degenstein Campus Center
56. Douglas E. Arthur Plaza
57. Cunningham Center for Music and Art
58. Bogar Hall
59. Selinsgrove Hall
60. Selbert Hall
61. Living Herbitorium
62. Steele Hall
63. Fisher Hall
64. Applebaum Hall
65. Weber Chapel Auditorium
66. Gebinger Medical Center at Susquehanna University
67. Writers Institute
68. Counseling Center
69. Arlin M. Adams Center for Law and Society
70. Student Housing
71. Natural Sciences Center
72. Susquehanna Children's Center
73. North Residence Hall
74. Art Studio
75. University Communications
76. Sigma Alpha Iota Sorority
77. Office of Admissions
78. Office of Financial Aid
79. Alumni House
80. Granada Townhouses
81. Hong Kong Townhouses
82. Jakarta Townhouses
83. Kathmandu Townhouses
84. Lima Townhouses
85. Montreal Townhouses
86. New Orleans Townhouses
87. Alice Springs Townhouses
88. Buenos Aires Townhouses
89. Cape Town Townhouses
90. Dalar Townhouses
91. Edinburgh Townhouses
92. Florence Townhouses
93. Department of Public Safety
94. Commons House

Parking Key

- A Admissions Visitors
- F Faculty and Staff
- G General (Permit Required)
- P Persons with Disabilities
- V Visitors
- S Students
- 1 First-Year Students
- C Commuter
- G Green Parking/Carpool
- E Emergency Phone

Reserved

- R General Parking 7 a.m. to 5 p.m.
- R Faculty and staff parking from 7 a.m. to 5 p.m.
- R General parking from 5 p.m. to 2 a.m.
- R No parking from 2 a.m. to 7 a.m.
- R Commuter/non-resident student permits are valid in all student spaces